

**C** **0580** — **09** **M** **A** **A** **S** **L** **0**

1 2 3 4 5 6 7 8 9

- 1. PRODUCTS: C: Connector
- 2. SERIES NO.: 0580
- 3. CONTACT NO.: 09, 15, 25, 37
- 4. CONTACT TYPE: M: Male
- 5. BODY OPTION: A: Metal Shell W/O S/R, B: Metal Shell W/Metal S/R, C: Metal Shell W/Plastic S/R, D: Plastic Shell W/O S/R, E: Plastic Shell W/Metal S/R, F: Plastic Shell W/Plastic S/R
- 6. MOUNTING OPTION: A: Through Hole
- 7. CONTACT PLATING: S: Selective Gold, G: Gold Flash, A: Gold 5U", B: Gold 10U", C: Gold 15U", D: Gold 30U"
- 8. INSULATOR COLOR: B: Black, G: Grey, L: Blue
- 9. FILL IT WITH "0"

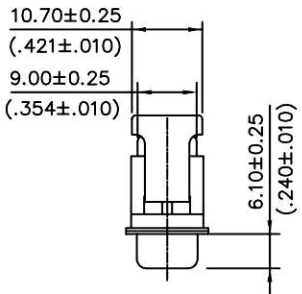

**SPECIFICATION :**

- .INSULATOR MATERIAL : PBT & G/F REINFORCED,UL 94-V0
- .CONTACT MATERIAL : BRASS, SELECTIVE GOLD PLATED OVER NICKEL
- .SHELL MATERIAL : SPCC, TIN OR NICKEL PLATED
- .STRAIN RELIEF MATERIAL : PBT & G/F REINFORCED,UL 94-V0
- .CURRENT RATING : 1 AMP.
- .INSULATION RESISTANCE : 1000M ΩMIN. (AT 500 V DC)
- .DIELECTRIC WITHSTANDING VOLTAGE : AC 500V MIN. (FOR 1 MIN)
- .OPERATING TEMPERATURE : -25°C TO +85°C
- .CONTACT RESISTANCE : 15m ΩMAX
- .WIRE SIZE : AWG 26 & 28 STRANDED , 1.27mm CONDUCTOR CENTRE FLAT CABLE

37	63.50(2.500)	69.40(2.732)	49.86/(1.963)	47.09/(1.854)	54.60/(2.150)	57.10/(2.248)	55.45/(2.183)	59.08/(2.326)	60.73/(2.391)
25	47.04(1.852)	53.09(2.090)	33.24/(1.309)	30.47/(1.200)	38.14/(1.502)	40.90/(1.610)	38.96/(1.534)	42.52/(1.674)	44.27/(1.743)
15	33.32(1.312)	39.10(1.539)	19.39/(.763)	16.62/(.654)	24.00/(.945)	26.60/(1.047)	25.25/(.994)	28.80/(1.134)	30.53/(1.202)
9	24.99/(.984)	30.80(1.212)	11.08/(.436)	8.31/(.327)	16.10/(.634)	18.60/(.732)	16.92/(.666)	20.47/(.806)	22.20/(.874)
NO. OF POSITIONS	±0.13 A (±.005)	±0.25 B (±.010)	±0.13 C (±.005)	±0.13 D (±.005)	±0.25 E (±.010)	±0.25 F (±.010)	±0.25 G (±.010)	±0.13/(.005) REAR MOUNTING	±0.13/(.005) FRONT MOUNTING

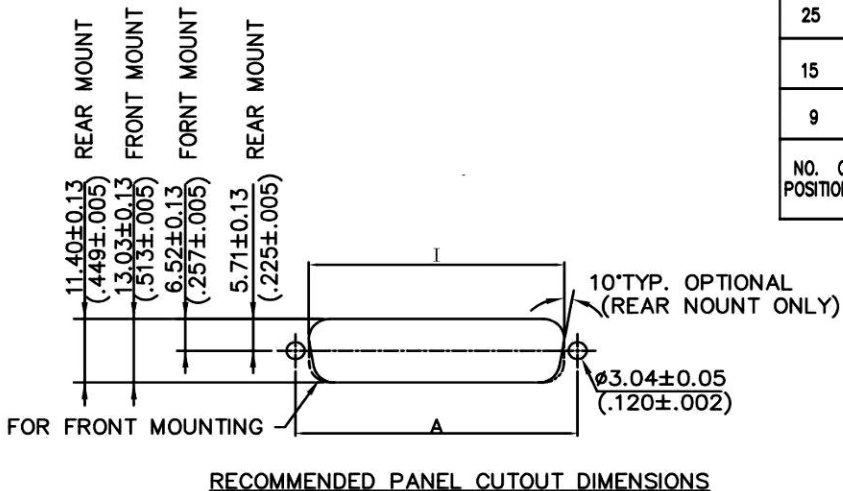

**RoHS Compliant**

**HSM 玄茂科技股份有限公司**

**HSUAN MAO TECHNOLOGY CO., LTD.**

APPD. 核准		TOLERANCE 容許公差	PART NAME 品名
DWG. 製圖	SCALE 比例	0 ± 0.25 .00 ± 0.38 ANG ±	D-SUB IDC TYPE XXP MALE METAL ROHS LOW-LEAD
DATE 制表日	UNIT 單位	SIZE 紙張尺寸	PART NO.
2010/5/7	MM	A 4	料號 C0580-XXMXAXX0R
	PAGE 張數	REV. 版本	
	1 OF 1	A	