

NOTES:

1. Rating: 300V 16A (IEC 250V 17.5A)
PITCH: 5.00mm
2. Insulation Withstands Voltage:
AC 1500 at 1 minute
3. Insulation Resistance:
500MΩ or more at DC500V
4. Using Temperature Range:
-40°C~+105°C
5. Screw Torque Value: 0.4 N·m
6. Suitable Electric Wire: AWG 24~14
(IEC 0.5~1.5mm²)
7. RoHS compliance
8. 12P以上产品用拼接方式处理

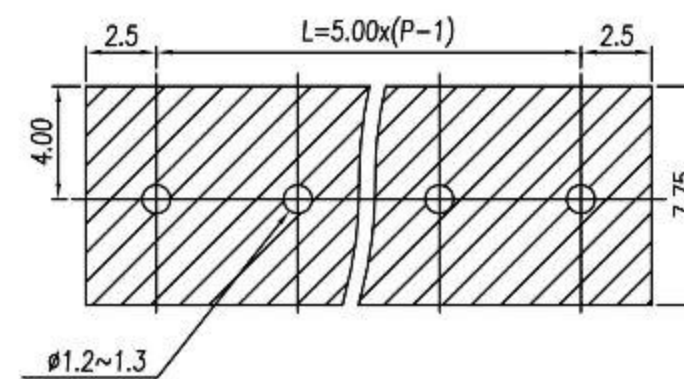
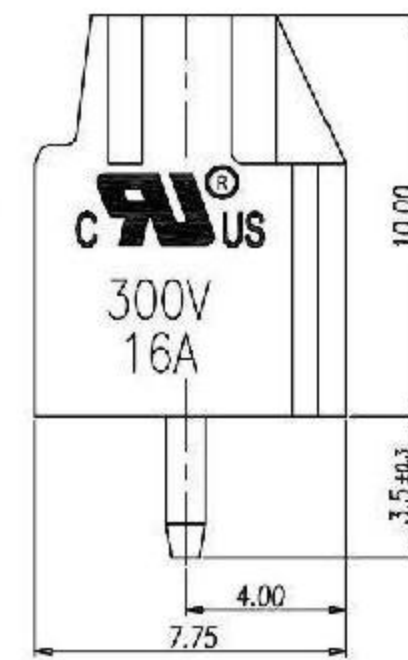

P.C.B. LAYOUT

Normal Geometric Tolerancing				
—		//	≡	⊥
0 to 100	0.2	0.3	0 to 10	0.2
over 100 to 150	0.3		over 10	0.3
over 150	0.5			
Total Pitch Tolerances			Normal dimension Tolerances	
0<U≤30	±0.20	0~30	±0.25	
30<U≤53	±0.25	over 30~53	±0.30	
53<U≤70	±0.30	over 53~70	±0.35	
70<U≤90	±0.35	over 70~90	±0.44	
90<U≤115	±0.44	over 90~115	±0.55	
115<U≤150	±0.55	over 115~150	±0.70	
150<U≤200	±0.70	over 150~200	±0.85	
200<U≤250	±0.85	over 200~250	±1.00	
250<U≤320	±1.00	over 250~320	±1.20	

ITEM	NAME OF PART	MATERIAL	NOTES
4	SCREW	STEEL	M2.5/Zn Plated
3	SOLDER PIN	COPPER ALLOY	Tin Plated
2	CLAMP	STAINLESS STEEL	
1	HOUSING	PA66	UL94-V0 GREEN

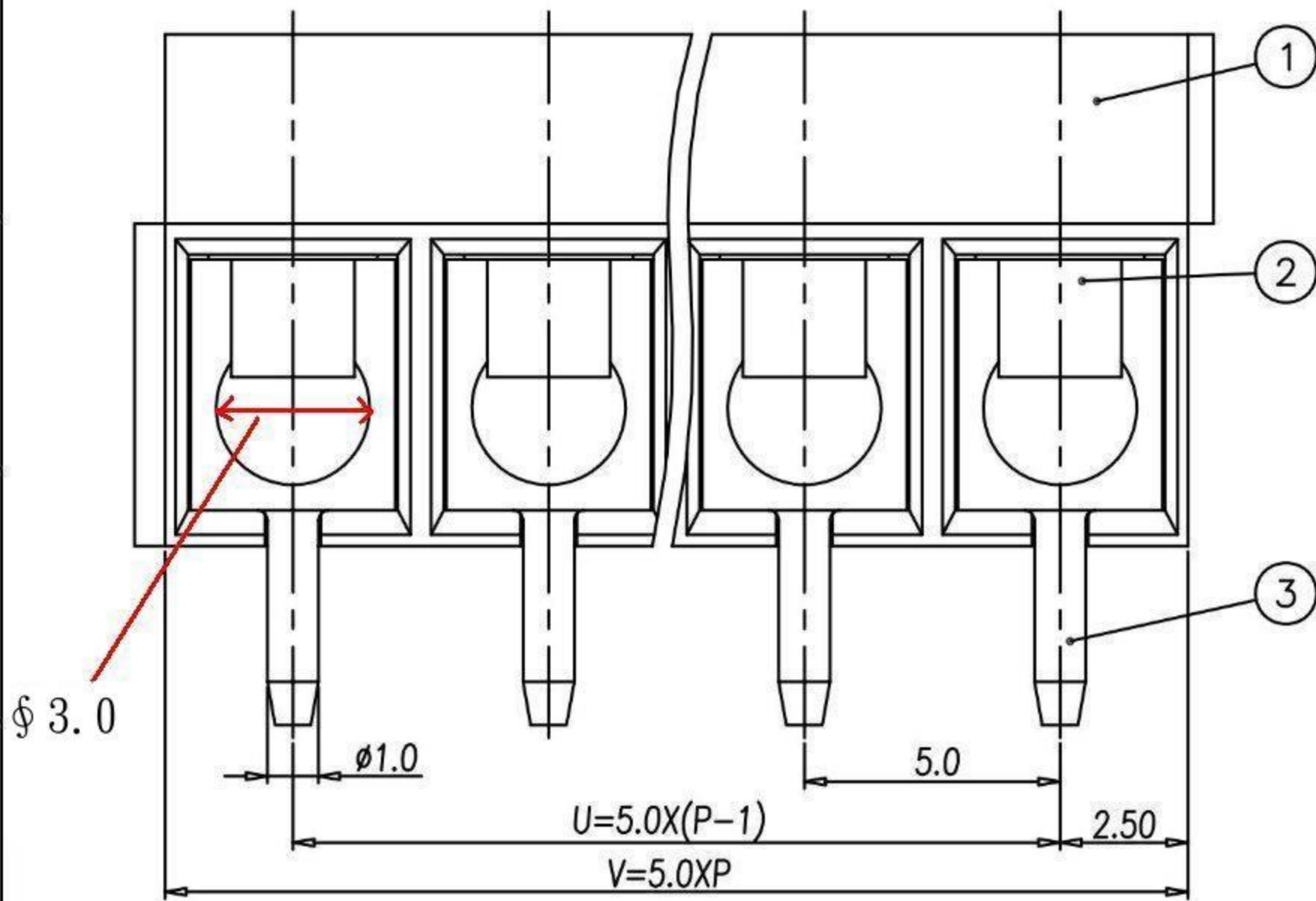

P	2	3	4	5	6	7	8	9	10	11	12
U	5.00	10.00	15.00	20.00	25.00	30.00	35.00	40.00	45.00	50.00	55.00
V	10.00	15.00	20.00	25.00	30.00	35.00	40.00	45.00	50.00	55.00	60.00

RoHS Compliant

HSM 玄茂科技股份有限公司
HSUAN MAO TECHNOLOGY CO., LTD.

APPD. 核准	SCALE 比例 参考 UNIT 单位 MM PAGE 张数 1 OF 1	TOLERANCE 容许公差 .0 ± .00 ± ANG. ±	PART NAME 品名 5.0mm TERMINAL BLOCK XXPIN STRAIGHT H=10mm 14-24AWG TIN PLATED GREEN INSULATOR ROHS
DWG. 製圖 Karen		SIZE 紙張尺寸 A4	
DATE 制表日 2012/2/9		REV. 版本 B	
PART NO. 料號		C0908-XXSTTE00R	