

1 2 3 4 5 6 7 8

A

A

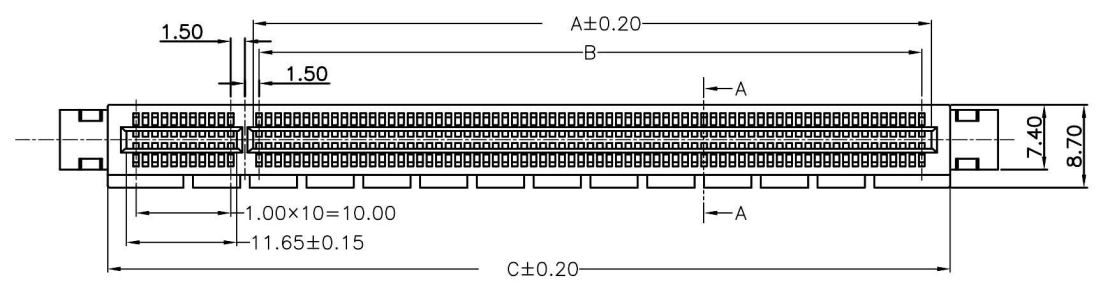

B

B

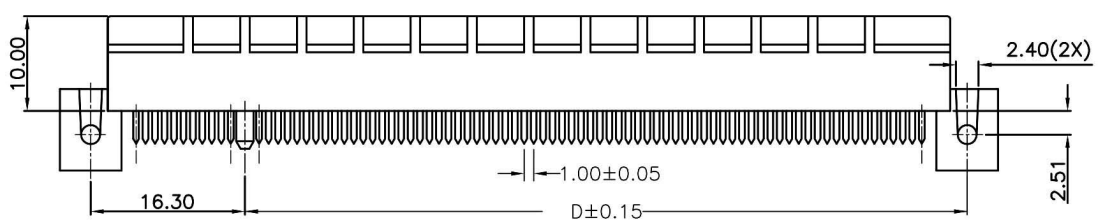

C

C

D

D

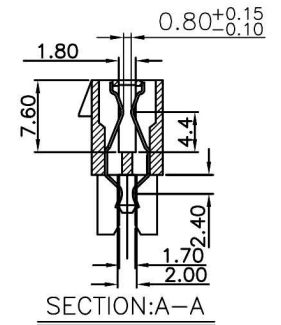
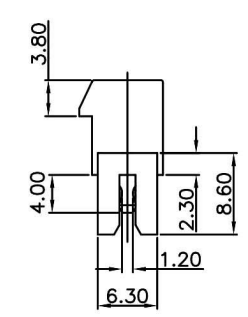

E

E

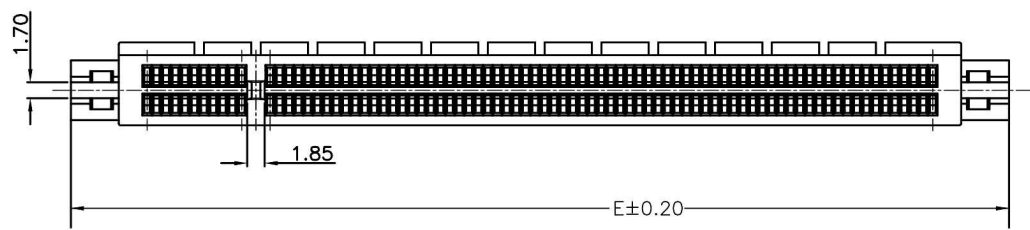

F

F

PIN數	A	B	C	D	E
36	7.65	6.00	25.00	12.30	35.10
64	21.65	20.00	39.00	26.30	49.10
98	38.65	37.00	56.00	43.30	66.10
164	71.65	70.00	89.00	76.30	99.10

Note:

- 1:Electical Performance
 - 1.1.Dielectric Withstanding Voltabge: 500V/AC For 1.0 Minute.
 - 1.2.Contadt Resistance:30mΩ Max
 - 1.3.linsulation Resistance:1000MΩ Min
- 2.Mechanical Performance.
 - 2.1.CONTACT INSERTION FORCE: 0.115Kg Max Per.Contact Pair.
 - 2.2.CONTACT WITHDRAWAL FORCE: 0.015Kg Min Per.Contact Pair.
 - 2.3.Terminal Retention Force (in housing): 0.5Kg Minper Terminal.
- 3.Material & Finish:
 - 3.1.Housing: Glass Filled Temperatuer Nylon 66, Black.
 - 3.2.Contact Plating: Tin Plating At Solder Tail Area; Gold Plating At Mating Area, All Over Nickel Plating.
- 4.Environmental:Operating Temperature: -55°C~+85°C

G

G

RoHS Compliant		HSM 玄茂科技股份有限公司 HSUAN MAO TECHNOLOGY CO., LTD.	
APPD. 核准	SCALE 比例 參考	METRIC 0 .00 .000 .0000 ANG	TOLERANCE ±0.20 ±0.10 ±0.001 ±.23
DWG. 製圖 Betty	UNIT 單位 MM	SIZE. 紙張尺寸 A 4	PART NAME 品名 1.0mm PCI Express Straddle Type With Ear XXPin Insulator Material:Nylon 66 Terminal:Brss Selective Gold Plating Tube Packing ROHS
DATE 制表日 2017/03/08	PAGE 張數 1 OF 1	REV. 版次 A	PART NO. 料號 C3614-XXABSBT0R

H

H

1 2 3 4 5 6 7 8