

107.60	22110
77.60	2280
57.60	2260
39.60	2242
27.60	2230
39.60	3042
27.60	3030
DIM.P	MODULE TYPE

<p>RoHS Compliant</p>		<p><b>HSM</b> 玄茂科技股份有限公司 HSUAN MAO TECHNOLOGY CO., LTD.</p>																	
<p>APPD. 核准</p>		<p>UNLESS OTHERWISE SPECIFIED TOLERANCE</p> <table border="1"> <tr> <th>UNIT:</th> <th>DECIMAL</th> <th>LINEAR</th> <th>ANGLES</th> </tr> <tr> <td>X</td> <td>±0.50</td> <td></td> <td>±5°</td> </tr> <tr> <td>XX</td> <td>±0.25</td> <td></td> <td>±3°</td> </tr> <tr> <td>XXX</td> <td>±0.12</td> <td></td> <td>±1°</td> </tr> </table>		UNIT:	DECIMAL	LINEAR	ANGLES	X	±0.50		±5°	XX	±0.25		±3°	XXX	±0.12		±1°
UNIT:	DECIMAL	LINEAR	ANGLES																
X	±0.50		±5°																
XX	±0.25		±3°																
XXX	±0.12		±1°																
<p>DWG. 製圖</p>	<p>Betty</p>	<p>SCALE 比例 參考</p>	<p>PART NAME 品名 0.5mm M.2 SOCKET CONNECTOR 67PIN SMT 90° H=8.5mm M KEY TYPE SELECTIVE GOLD PLATING BLACK INSULATOR REEL PACKING ROHS</p>																
<p>DATE 制表日</p>	<p>2020/06/23</p>	<p>UNIT 單位</p> <p>M M</p>	<p>PART NO. 料號 C3625-67DMSBR0R</p>																
		<p>PAGE 張數</p> <p>2 OF 3</p>																	

1 2 3 4 5 6 7 8

A  
B  
C  
D  
E  
F  
G  
H

A  
B  
C  
D  
E  
F  
G  
H

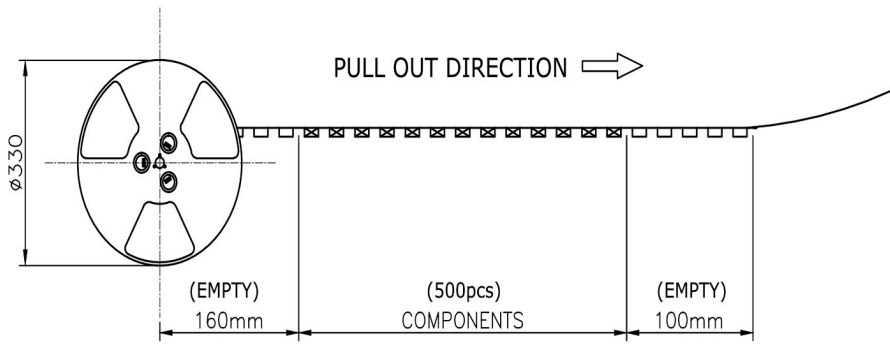

PACKAGING SPECIFICATION:

Quantity:  
500 Piece/ Reel  
5 Reel/ Carton  
2,500 Piece/ Outer Carton

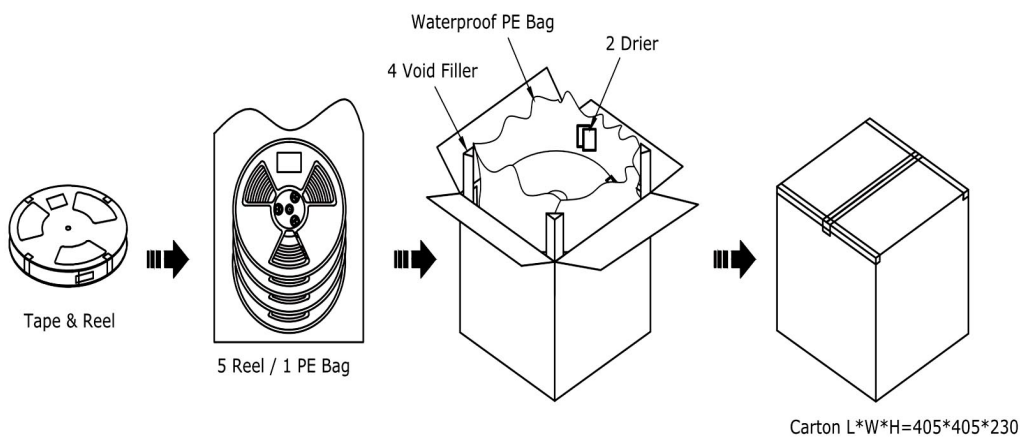
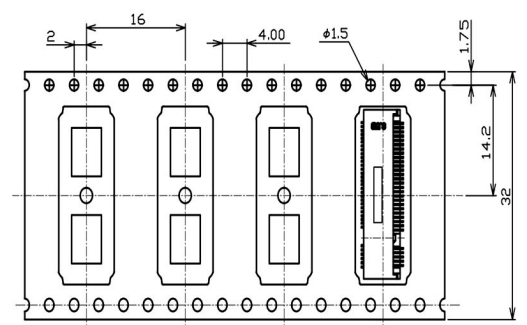

RoHS Compliant		<b>HSM</b> 玄茂科技股份有限公司		<b>HSUAN MAO TECHNOLOGY CO., LTD.</b>	
APPD. 核准	SCALE 比例 参考	UNITS: DECIMAL LINEAR ANGLES X. ±0.50 45° X.X ±0.25 43° X.XX ±0.12 41°	PART NAME 品名		
DWG. 製圖 Betty			0.5mm M.2 SOCKET CONNECTOR 67PIN		
DATE 制表日	UNIT 單位 M M	SIZE 紙張尺寸 A 4	SMT 90° H=8.5mm M KEY TYPE SELECTIVE		
2020/06/23	PAGE 張數 3 OF 3	REV. 版次 A	GOLD PLATING BLACK INSULATOR		
			REEL PACKING ROHS		
			PART NO. 料號 C3625-67DMSBR0R		

1 2 3 4 5 6 7 8

1 2 3 4 5 6 7 8

A  
B  
C  
D  
E  
F  
G  
H

A  
B  
C  
D  
E  
F  
G  
H

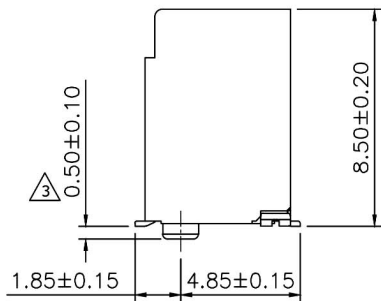
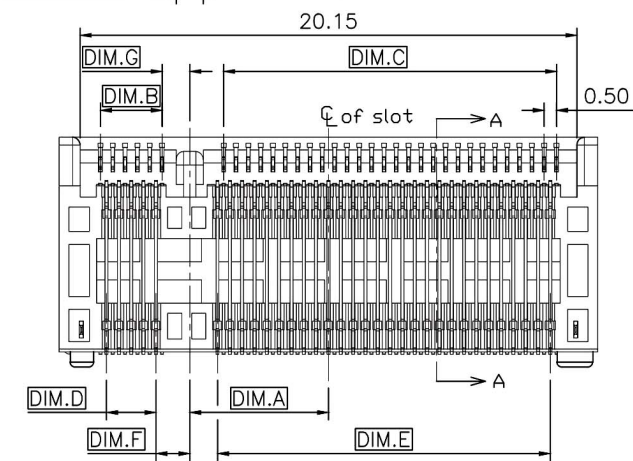
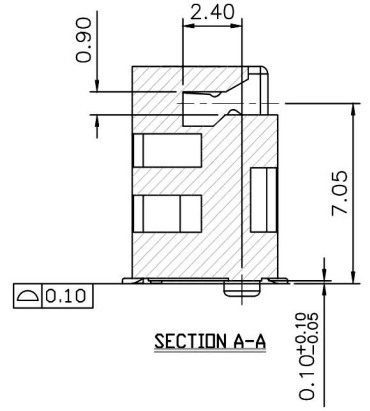
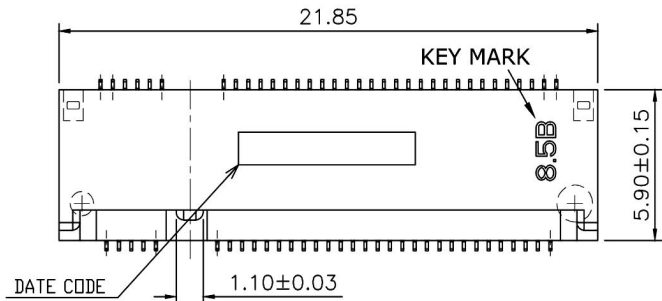

Notes:

Material:

1. Housing: High Temperature Thermoplastic, UL94V-0, Black
2. Contacts: Copper Alloy, gold plated on contact area and gold flash solder area. 50u" min nickel under-plating overall.
3. Peg: Copper Alloy, 50~120u" min matte-tin plated on soldering area. 50u" min. nickel under-plating.
4. Reflow Solder Capable to 260°C
5. Datecode: YYWWD

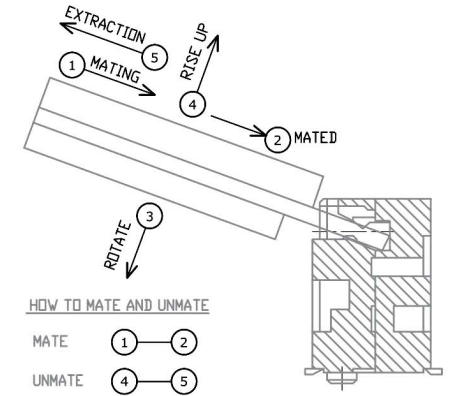

HOW TO MATE AND UNMATE

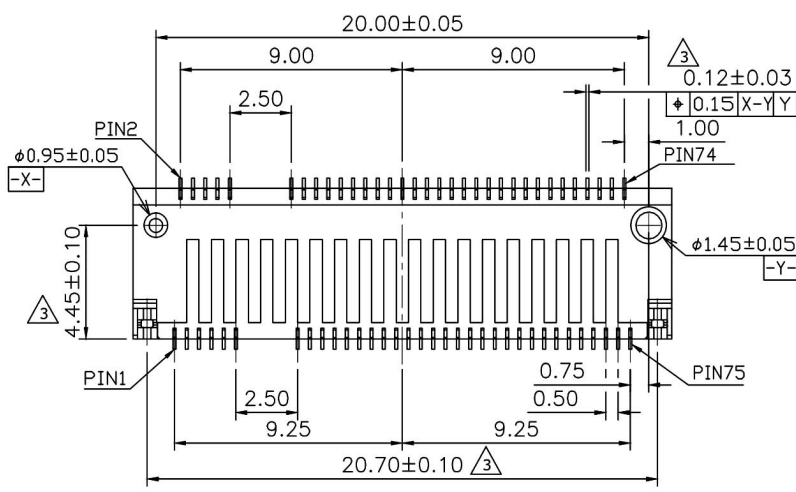

DIMENSION TABLE							
M	-6.125	14.0	2.0	14.0	1.5	1.125	1.375
Key	DIM.A	DIM.B	DIM.C	DIM.D	DIM.E	DIM.F	DIM.G

RoHS Compliant **HSM** 玄茂科技股份有限公司 **HSUAN MAO TECHNOLOGY CO., LTD.**

APPD. 核准	SCALE 比例 参考	UNITS: DECIMAL LINEAR ANGLES X. ±0.50 45° XX ±0.25 ±3° XXX ±0.12 ±1°	PART NAME 品名 0.5mm M.2 SOCKET CONNECTOR 67PIN SMT 90° H=8.5mm M KEY TYPE SELECTIVE GOLD PLATING BLACK INSULATOR REEL PACKING ROHS
DWG. 製圖 Betty			
DATE 制表日 2020/06/23	UNIT 單位 MM	REV. 版次 A	PART NO. 料號 C3625-67DMSBR0R
	PAGE 張數 1 OF 3		

1 2 3 4 5 6 7 8